

PLAN SHOWING THE PROPOSED CONSTRUCTION OF
 GROUND FLOOR (4.95 M HEIGHT) SHOP USE
 COMMERCIAL BUILDING AT PLOT NO: 2 IN APPROVED
 SUBDIVISION, MANAPAKKAM MAIN ROAD,
 MANAPAKKAM, CHENNAI - 600 125
 IN S.NO.37/1A2 (PART) OF MANAPAKKAM VILLAGE
 GREATER CHENNAI CORPORATION.
 DIVISION NO-157 ZONE NO-12
 CLF. G.L. 6.1 (5) (1)
 15.6.2020 P/NHRB/3(B)/0559/2020

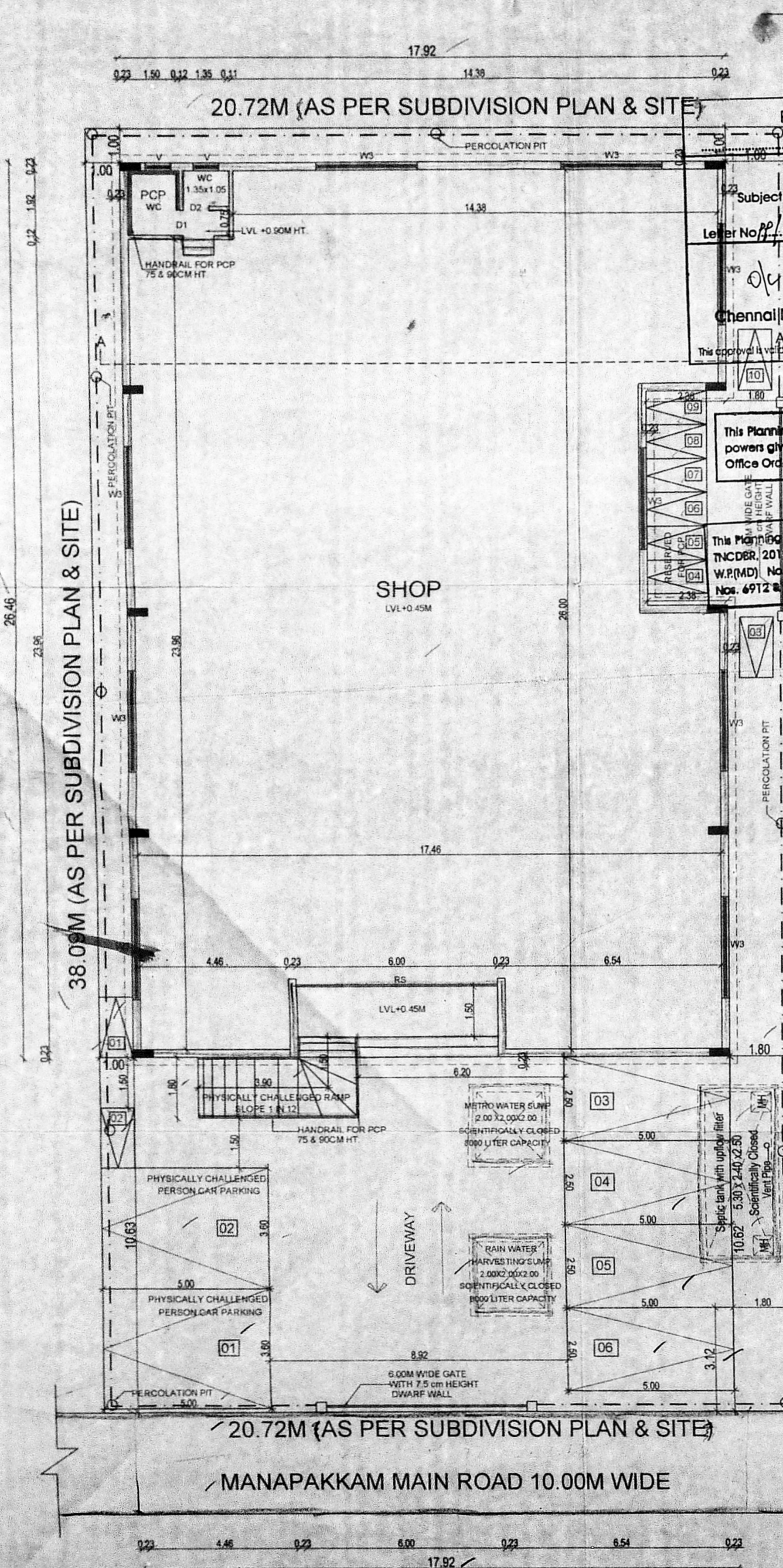

Planning Permission No.
B/NHRB/357/2020
APPROVED
 Subject to conditions mentioned in this office
 Letter No. **P/NHRB/3(B)/0559/2020** Dated **23.10.2020**
 Senior Planner
 Chennai Metropolitan Development Authority
 Chennai-600 008.
 This approval is valid only after Building Permit is issued by the concerned local authority.
 This Planning Permission as per the delegated powers given by Member Secretary, CMDA in Office Order No. 7/2019 dated 12.03.2019.
 This Planning Permission Issued under New Rule, MCDR, 2019 is subject to final outcome of the W.P.(MD) No. 5928 of 2019 and WMP (MD) No. 6912 of 2019.

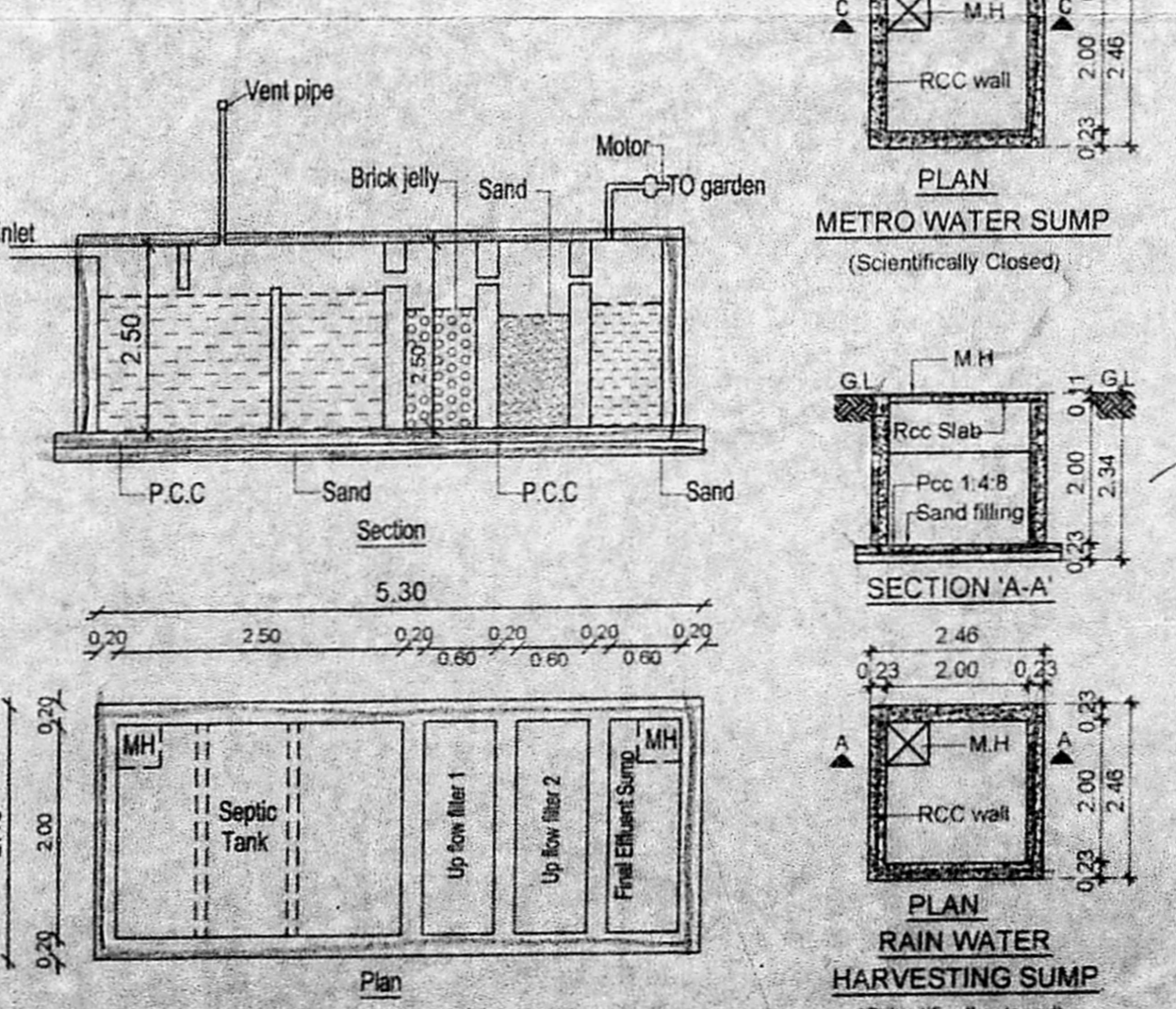
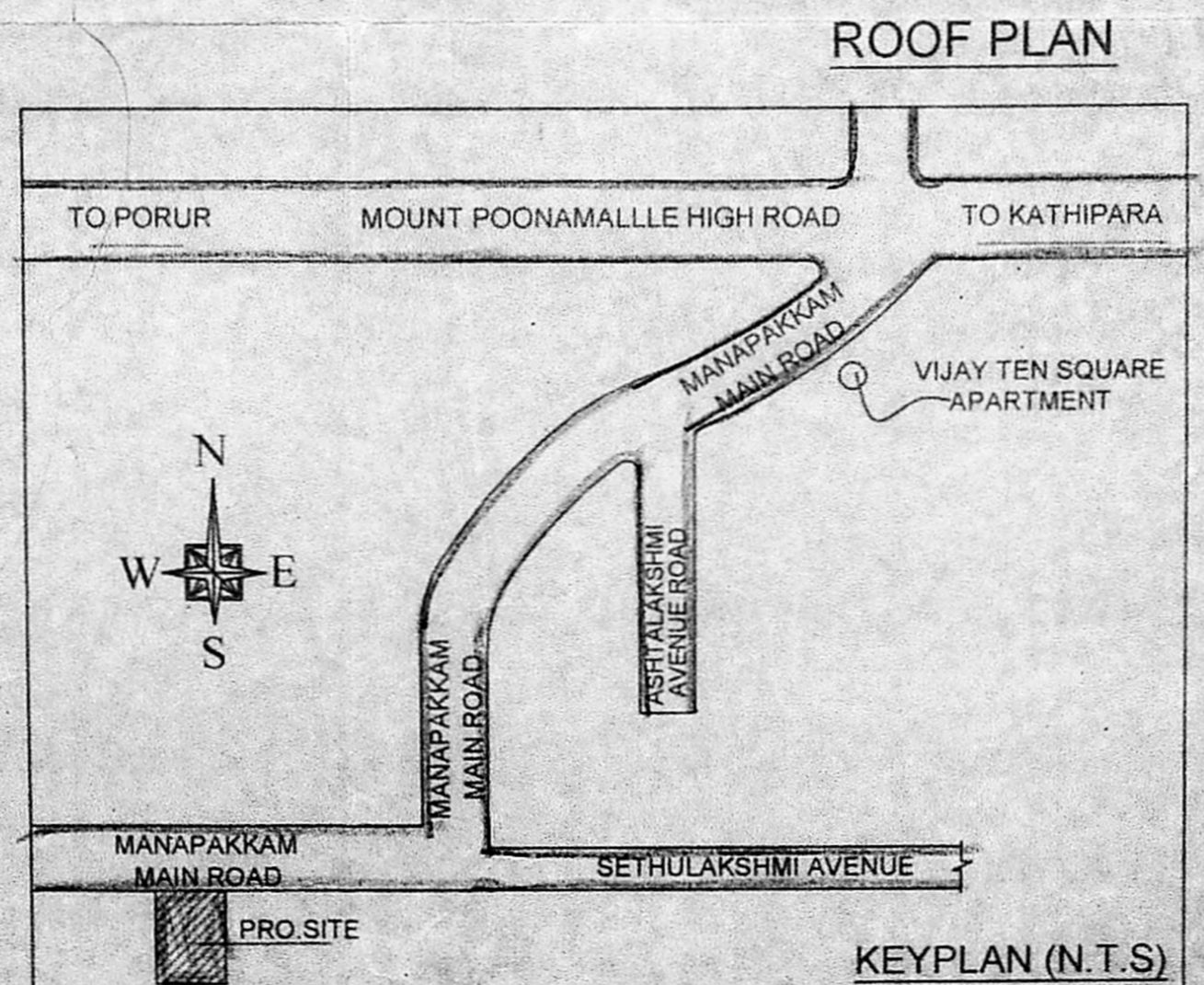
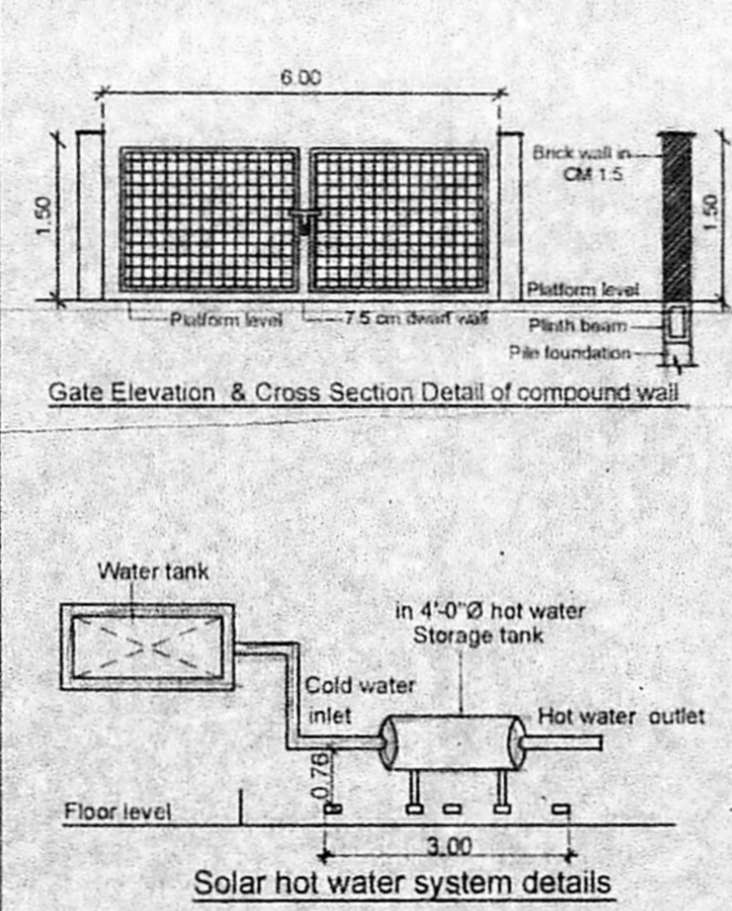
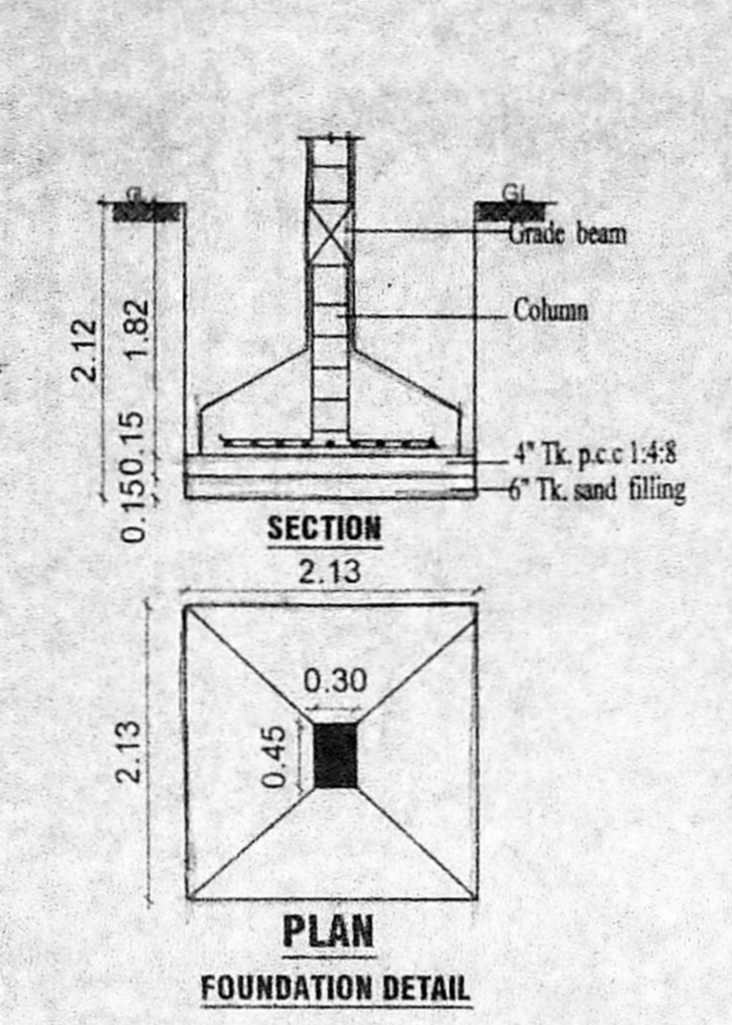
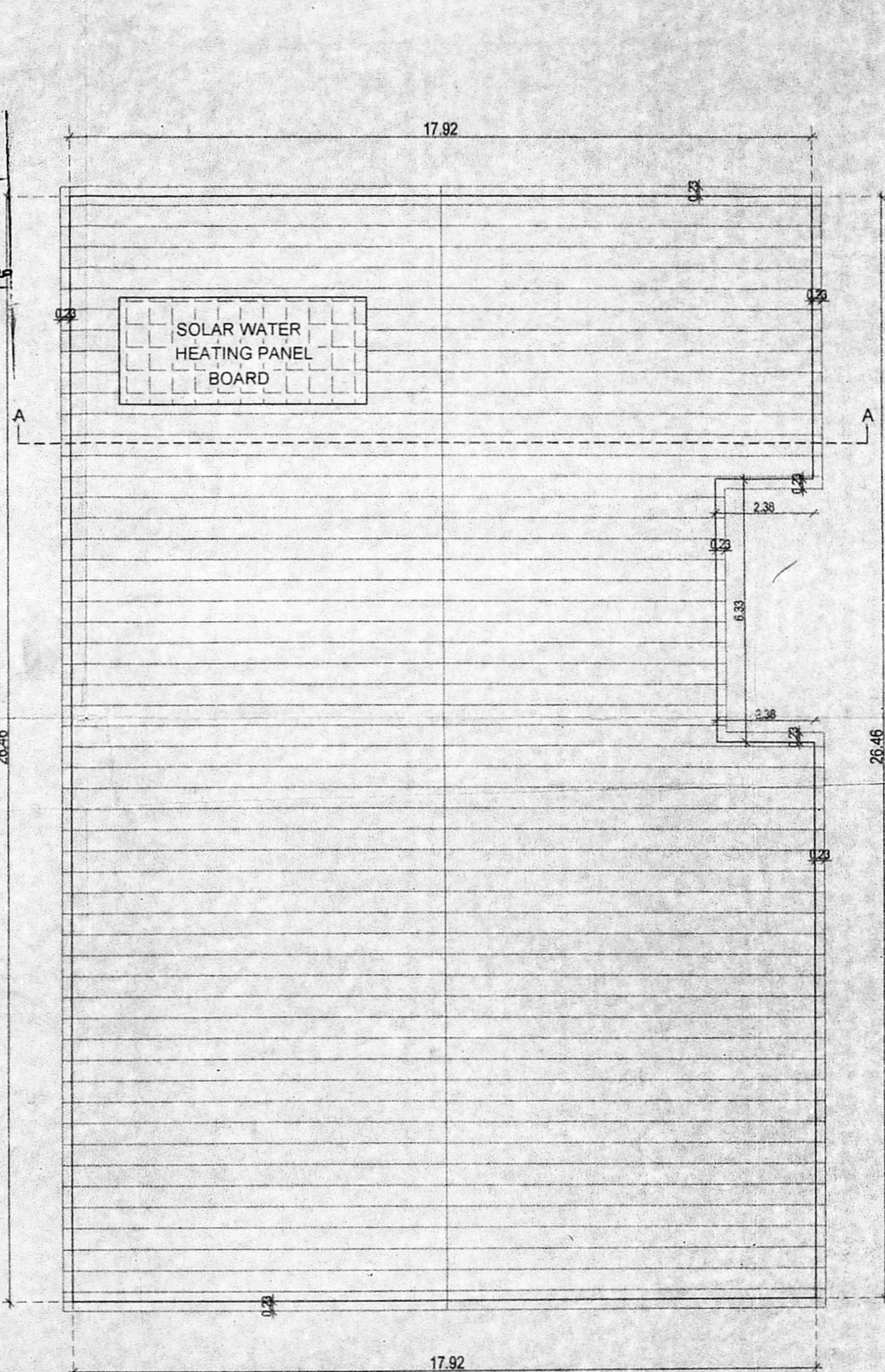

JOINERY DETAILS

RS	ROLLING SHUTTER	0.80 x 2.10
D1	FLOOR DOOR	0.90 x 2.10
D2	DOOR	0.76 x 2.10
O	OPENING	0.90 x 2.10
W3	WINDOW	3.00 x 1.35
V	VENTILATOR	0.76 x 0.60

SPECIFICATION
 BRICK WORK : SUPER STRUCTURE WITH MAIN WALL USING CM 1.5
 MORTAR PARAPET WALL CM 1.4 MORTAR.
 WOOD WORK : MAIN DOOR TEAK, AND OTHER DOORS KONGU WOOD
 RCC WORK : MINIMUM GRADE OF CONCRETE M25 (1:1:2)
 FLOORING : ALL ROOM CERAMICS TILES FLOORING
 PLASTERING WORK : PLASTERING WORK IN CM 1.4
 WEATHERING COURSE : WEATHERING COURSE IN BRICK JELLY CONCRETE IN C.M WITH TWO COURSES OF FLAT TILES LAID TO DETAIL.

COLOR INDEX
 PROPOSED [Symbol] ROAD [Symbol] BOUNDARY [Symbol]

SCALE 1: 100
 AREA DETAILS

S.NO.	PLOT AREA DETAILS IN SQ.M	
1	AS PER APPROVED SUBDIVISION PLAN	789.23 sq.m
FSI AREA DETAILS IN SQ.M		
S.NO.	FLOOR	F.S.I AREA
1	GROUND FLOOR	459.13
2	TOTAL	459.13
3	FSI	0.581

PARKING DETAILS
 CAR PARKING REQUIRED : 6 NOS.
 CAR PARKING PROVIDED : 6 NOS.
 TWO WHEELER PARKING REQUIRED : 6 NOS.
 TWO WHEELER PARKING PROVIDED : 10 NOS.

REF : SUBDIVISION APPROVED VIDE : SD/WDCN12/00355/2019
 DATED : 24/02/2020

OWNER
 VASUDEVAN T.J.M.Arch
 REGISTERED ARCHITECT & INTERIOR DESIGNER
 REGD. No: CA/90/13009
 CMDA-RA/GR. V19/01/025 GCC-RA/1009/2019
 Plot No.6 School Road, Manapakkam, Chennai-600 125
 Adyar, Chennai-600 044
 044-26634000
 vasu@vasuarch.com

LICENSED SURVEYOR